

1 | 2 | 3 | 4 | 5 | 6 | 7 | 8

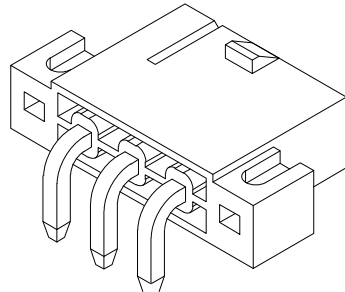

■ SPECIFICATIONS

- Voltage Rating: 600V AC, DC
- Current Rating: 9A, AC/DC
- Withstanding Voltage: 1500V AC/minute
- Insulation Resistance: 1000M min
- Temperature Range: -25°C~+85°C
- Contact resistance: Intial value/10m max
- After enviornment testing/20m max

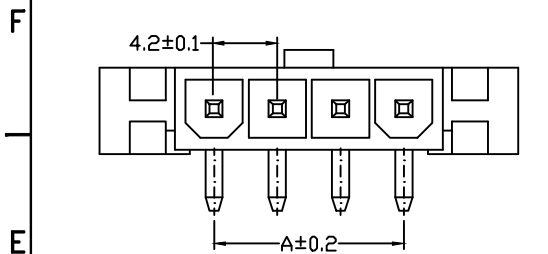
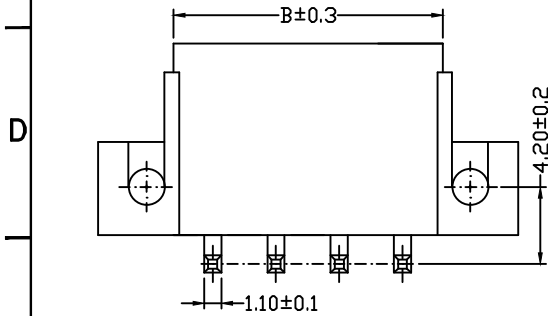

■ WAFER

- Part No.:M4201LWR
- Material: Nylon 66 UL 94V-0 or UL94V-2
- Mates with HLB M4201 series single row Housing
- Q'ty: 1000pcs/bag

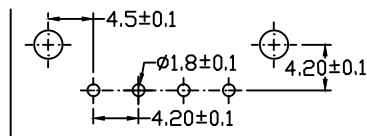
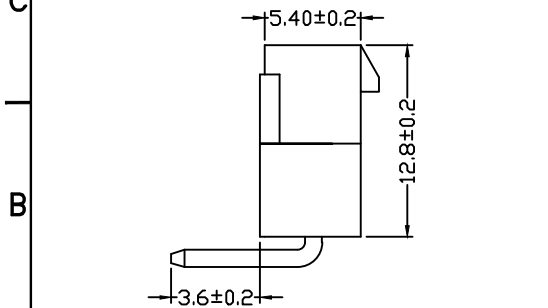

RECOMMAND PCB LAYOUT

Poles	Part No	Dimensions (mm)	
		A	B
2	M4201LWR-1*02	4.20	9.60
3	M4201LWR-1*03	8.40	13.80
4	M4201LWR-1*04	12.60	18.00
5	M4201LWR-1*05	16.80	22.20
6	M4201LWR-1*06	21.00	26.40
7	M4201LWR-1*07	25.20	30.60
8	M4201LWR-1*08	29.40	34.80
9	M4201LWR-1*09	33.60	39.00
10	M4201LWR-1*10	37.80	43.20
11	M4201LWR-1*11	42.00	47.40
12	M4201LWR-1*12	46.20	51.60

							GENERAL TOLERANCE				东莞市翰皓精密电子有限公司				PART NO. M4201LWR-1*XX			
							.X ±0.30				Dongguan HanHao Precision Electronics Co.,Ltd				TITLE 4.2 mm Crimp Style Connectors			
							.XX ±0.20				APPROVAL Smark		CHECK Yu wei		DRAWN Liu Yan		DATA 2010/06/22	
							.XXX ±0.10				PROJECT				UNIT mm		SCALE 1:1	
2010/06/22	A	B		Modify frame format	Jova	Jova Lau												
DATE	OLD REV	NEW REV	ECN	DESCRIPTION	CHECK	APPROVAL												
1																		

1 | 2 | 3 | 4 | 5 | 6 | 7 | 8

1 2 3 4 5 6 7 8

F
E
D
C
B
A

F
E
D
C
B
A

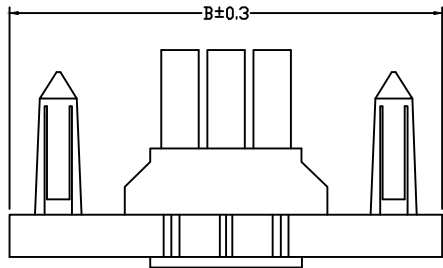
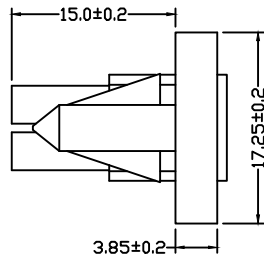
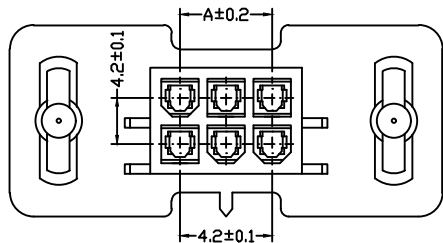

■ SPECIFICATIONS

- Voltage rating: 600V AC, DC
- Current rating: 9A, AC, DC
- Withstanding Voltage: 1500V AC/minute
- Insulation resistance: 1000M min
- Temperature range: -25°C~+85°C
- Applicable PC board thickness: .063" (1.6mm)
- Contact resistance: Initial Value/10m max
- After environmental testing/20m max

■ WAFER

- Part No.: M4202FHL
- Material: Nylon 66 UL 94V-0 or UL 94V-2
- Q'ty: 1000pcs/bag

Poles	Part No	Dimensions (mm)	
		A	B
4	M4202FHL-2*02	4.20	40.20
6	M4202FHL-2*03	8.40	44.40
8	M4202FHL-2*04	12.60	48.60
10	M4202FHL-2*05	16.80	52.80
14	M4202FHL-2*07	25.20	61.20
18	M4202FHL-2*09	33.60	69.60
24	M4202FHL-2*12	37.80	82.20
36	M4202FHL-2*18	46.20	107.40

2010/06/22	A	B		Modify frame format	Jova	Jova Lau
DATE	OLD REV	NEW REV	ECN	DESCRIPTION	CHECK	APPROVAL

GENERAL TOLERANCE
 .X ±0.30
 .XX ±0.20
 .XXX ±0.10

PROJECT

东莞市翰皓精密电子有限公司
 Dongguan HanHao Precision Electronics Co.,Ltd

APPROVAL: Smark
 CHECK: Yu wei
 DRAWN: Liu Yan
 DATA: 2011/01/22

PART NO. M4202FHL-XX

TITLE 4.2 mm Crimp Style Connectors

UNIT: mm
 SCALE: 1:
 NUMBER: 8
 REV: B

1 2 3 4 5 6 7 8

1 2 3 4 5 6 7 8

F
E
D
C
B

F
E
D
C
B

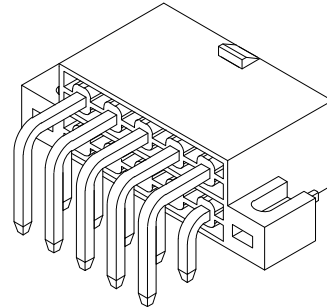
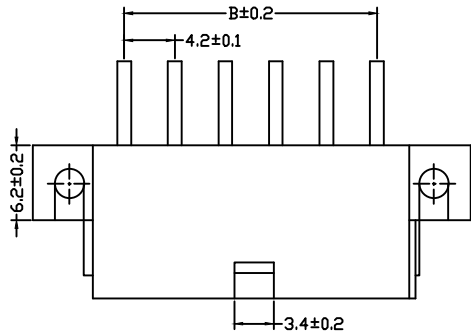

■ SPECIFICATIONS

- Voltage rating: 600V AC, DC
- Current rating: 7A, AC, DC
- Withstanding Voltage: 1500V AC/minute
- Insulation resistance: 1000M min
- Temperature range: -40°C~+105°C
- Contact resistance: Initial Value/10m max
- After environmental testing/20m max

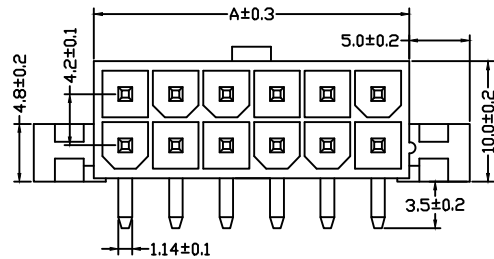

■ WAFER

- Part No.: M4202LWR
- Material: Contact: Brass, Tin plated
- Base: Nylon 66 UL 94V-2 or UL 94V-0
- Mates with HLB M4202 series single row Housing
- Q`ty: 1000pcs/bag

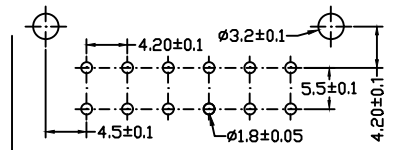
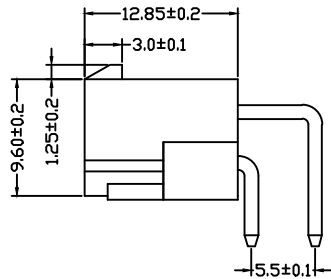

RECOMMEND PCB LAYOUT

Poles	Part No	Dimensions (mm)	
		A	B
02	M4202LWR-2*01	5.40	---
04	M4202LWR-2*02	9.60	4.20
06	M4202LWR-2*03	13.80	8.40
08	M4202LWR-2*04	18.00	12.60
10	M4202LWR-2*05	22.20	16.80
12	M4202LWR-2*06	26.40	21.00
14	M4202LWR-2*07	30.60	25.20
16	M4202LWR-2*08	35.80	29.40
18	M4202LWR-2*09	39.00	33.60
20	M4202LWR-2*10	43.20	37.80
22	M4202LWR-2*11	47.40	42.00
24	M4202LWR-2*12	51.60	46.20

							GENERAL TOLERANCE				PART NO.			
							.X ±0.30				M4202LWR-2*XX			
							.XX ±0.20				TITLE			
							.XXX ±0.10				4.2 mm Crimp Style Connectors			
2010/06/22	A	B		Modify frame format	Jova	Jova Lau	APPROVAL	CHECK	DRAWN	DATA	UNIT	SCALE	NUMBER	REV
DATE	OLD REV	NEW REV	ECN	DESCRIPTION	CHECK	APPROVAL	Smark	Yu wei	Liu Yan	2011/01/22	mm	1 :	8	B
1														

1 2 3 4 5 6 7 8

东莞市翰皓精密电子有限公司
Dongguan HanHao Precision Electronics Co.,Ltd

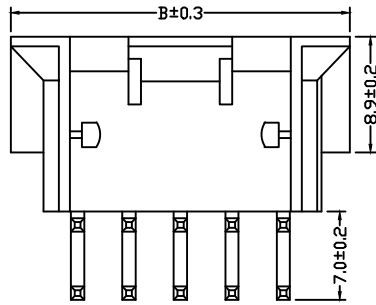
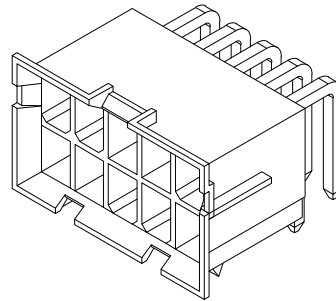
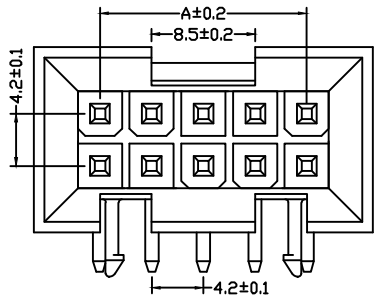

■ SPECIFICATIONS

- Voltage rating: 600V AC, DC
- Current rating: 9A, AC, DC
- Withstanding Voltage: 1500V AC/minute
- Insulation resistance: 1000M min
- Temperature range: -25°C~+85°C
- Applicable PC board thickness: .063" (1.6mm)
- Contact resistance: Initial Value/10m max
- After environmental testing/20m max

■ WAFER

- Part No.: M4202WRA
- Material: Nylon 66 UL 94V-2
- Mates with HLB M4202M series dual row Housing
- Q'ty: 1000pcs/bag

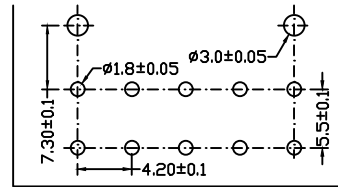
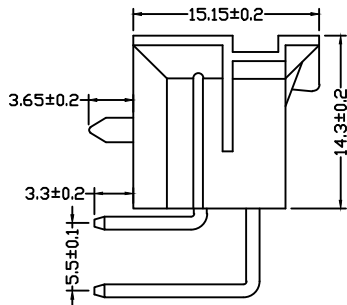

RECOMMEND PCB LAYOUT

Poles	Part No	Dimensions (mm)	
		A	B
4	M4202WRA-2*02	4.20	15.00
6	M4202WRA-2*03	8.40	19.20
10	M4202WRA-2*05	16.80	27.60
14	M4202WRA-2*07	25.20	36.00
16	M4202WRA-2*08	29.40	40.20
18	M4202WRA-2*09	33.60	44.40
24	M4202WRA-2*12	46.20	57.00
36	M4202WRA-2*18	71.40	82.20

							GENERAL TOLERANCE				东莞市翰皓精密电子有限公司 Dongguan HanHao Precision Electronics Co.,Ltd				PART NO. M4202WRA*XX			
							.X ±0.30 .XX ±0.20 .XXX ±0.10				APPROVAL				TITLE 4.2 mm Crimp Style Connectors			
							PROJECT				Smark				Yu wei			
							PROJECT				Liu Yan				2011/01/22			
DATE	OLD REV	NEW REV	ECN	DESCRIPTION	CHECK	APPROVAL					UNIT	SCALE	NUMBER	REV				
2010/06/22	A	B		Modify frame format	Jova	Jova Lau					mm	1:	8	A				

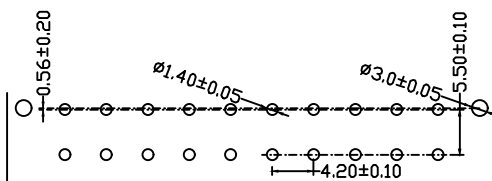
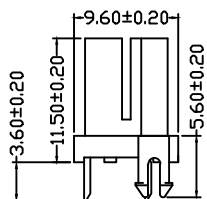
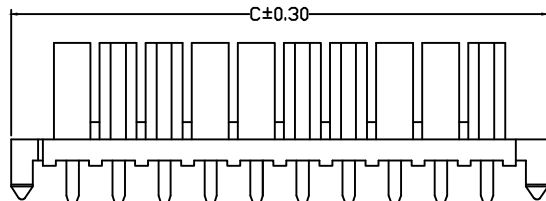
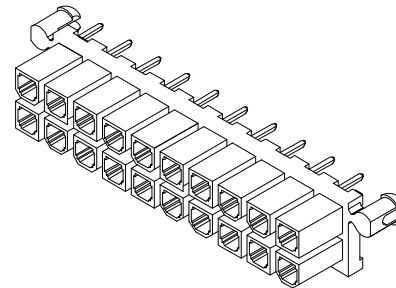
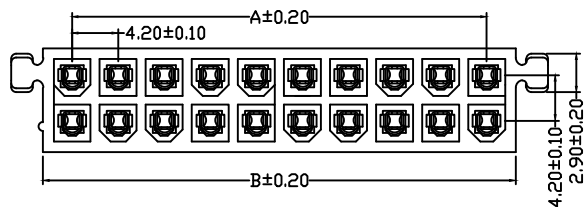

RECOMMEND PCB LAYOUT

■ SPECIFICATIONS

- Voltage rating: 600V AC, DC
- Current rating: 9A, AC, DC
- Withstanding Voltage: 1500V AC/minute
- Insulation resistance: 1000M min
- Temperature range: -25°C~+85°C
- Applicable PC board thickness: .063" (1.6mm)
- Contact resistance: Initial Value/10m max
- After environmental testing/20m max

■ WAFER

- Part No.: M4202WVS
- Material: Contact: Brass or Phosphor Bronze
- Finish: Tin-plated or Gold flash
- Material: Nylon 66 UL94V-2 or UL94V-0
- Mates with HLB M4202M M4202H series
- dual row housing
- Q'ty: 1000pcs/bag

Poles	Part No	Dimensions		
		A	B	C
02	M4202WVS-2*01	---	5.50	11.60
04	M4202WVS-2*02	4.20	9.70	15.80
06	M4202WVS-2*03	8.40	13.90	20.00
08	M4202WVS-2*04	12.60	18.10	24.20
10	M4202WVS-2*05	16.80	22.30	28.40
12	M4202WVS-2*06	21.00	26.50	32.60
14	M4202WVS-2*07	25.20	30.70	36.80
16	M4202WVS-2*08	29.40	34.90	41.00
18	M4202WVS-2*09	33.60	39.10	45.20
20	M4202WVS2*10	37.80	43.30	49.40
22	M4202WVS2*11	42.00	47.50	53.60
24	M4202WVS-2*12	46.20	51.70	57.80

DATE	OLD REV	NEW REV	ECN	DESCRIPTION	CHECK	APPROVAL
2010/06/22	A	B		Modify frame format	Jova	Jova Lau

GENERAL TOLERANCE

- .X ±0.30
- .XX ±0.20
- .XXX ±0.10

PROJECT



东莞市翰皓精密电子有限公司
Dongguan HanHao Precision Electronics Co.,Ltd

APPROVAL	CHECK	DRAWN	DATA
Smark	Yu wei	Liu Yan	2010/06/22

PART NO.			
M4202WVS-2*XX			
TITLE			
4.2 mm Crimp Style Connectors			
UNIT	SCALE	NUMBER	REV
mm	1:	8	B